

Instructions

Drawing No. : APT0.507.007.1

Before installing the device, please read the instructions.

Summary

Main application

TL-50 Series tower Lamp is widely used in all kinds of control circuits, e.g.mechanism, electric power, chemical industry, ship,railway, metallurgy. It serves as a alert signal, operation indication and remote control.

General product information:

Model specification

TL-50 ☐ ☐ ☐/ ☐ ☐ ☐ ☐

① ② ③ ④ ⑤ ⑥ ⑦ ⑧

- ① Tower lamp type
- ② Product Auxiliary specification: 0 (unmarked) ; 1
- ③ Light source: L (LED) 、 B (bulb)
- ④ Glowing forms L:Permanent F:flashing
- ⑤ Sound forms: I :intermittent、 C:continuous、 unmarked:soundless
- ⑥ Color: r -red、 g -green、 y-yellow、 b-blue、 w -white
- ⑦ Voltage class: 22 (AC/DC12V) 、 23 (AC/DC24V) 、 26 (AC/DC110V) 、 31 (AC220V)
- ⑧ Auxiliary code

Installation caution

- 1) We need to check whether the type meet selection requirement.
- 2) We must turn off power before installation and recondition.
- 3) Choose the correct operational voltage
- 4) Avoid chemicals to touch product.

Technical feature

Parameters

- 1) Rated insulation voltage (Ui) : 440V
- 2) Power frequency withstand voltage :AC1890V , 50Hz, 5s
- 3) Rated voltage/ rated current:

Rated voltage/rated current	voltage	LED	bulb	buzzer
Ue/Ie (single component)	AC/DC12V	60mA	260mA	15mA~40mA
	AC/DC24V	40mA	130mA	
	AC/DC110V	25mA	30mA	
	AC220V	25mA	16mA	
voltage fluctuation range	±10%Ue			
rated frequency (alternating current)	40 ~ 60Hz			
buzzer volume	E85dB(test distance is 10 meters from the sound source in horizontal direction)			

Operation condition

- 1) Environment temperature:-5℃~+40℃

- 2) Altitude : ≤ 2000 meters
- 3) Pollution class : III
- 4) Degree of protection : IP20
- 5) Relative air humidity : $\leq 98\%$

Installation

Mounting type

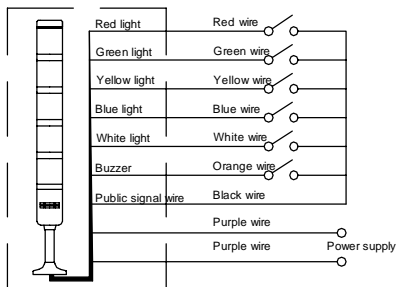
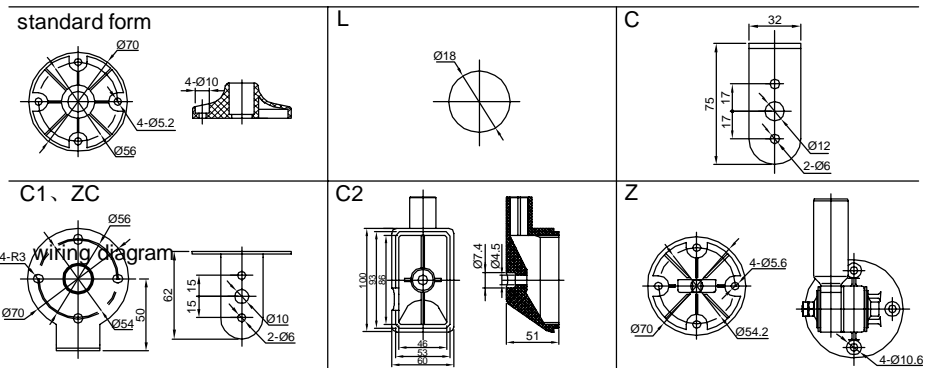

Flashing

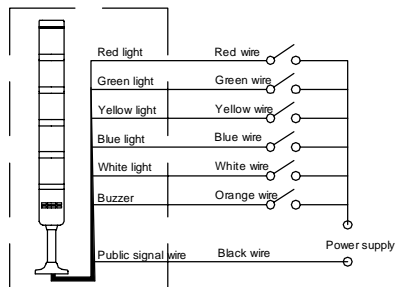

Permanent

Replace method of LED and bulb(left picture)

Appearance dimension(right picture)

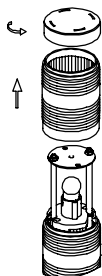

- Step1. Open roof cover
 - Step2. pick off the shell from down to up.
 - Step3. Replace the same voltage LED or bulb.
- Note: different colors of LED and shell could exchange freely.

